

REV	Revision date	Drawing/Date	Audit/Date
A	New Issue	Yu Chao/25 Apr 2014	

## Material characteristics

Screw: M2.5 Carbon steel  
 Needle: Copper Tin planting  
 Shrapnel: Copper Tin planting  
 Plastic parts: PA66 UL94V-0

Mechanical properties

## Mechanical properties

Temperature range:  $-40^{\circ}\text{C} \sim 120^{\circ}\text{C}$

Trim length: 5~6mm

Torque: 0.4N.m

Pitch: 5.0mm

## Technical Parameters

Rated Voltage: 250V

Rated Current: 10A

Wire Size: 0.5-1.5mm<sup>2</sup>

Dielectric strength: AC2000V/Min

Insulation Resistance: 500MΩ

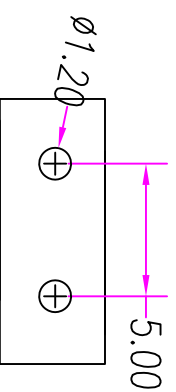
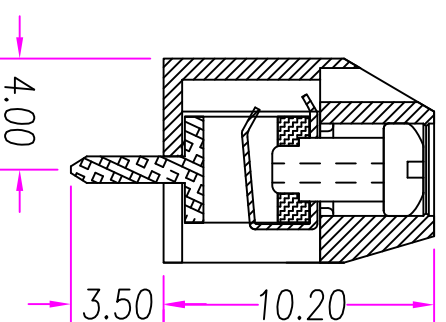
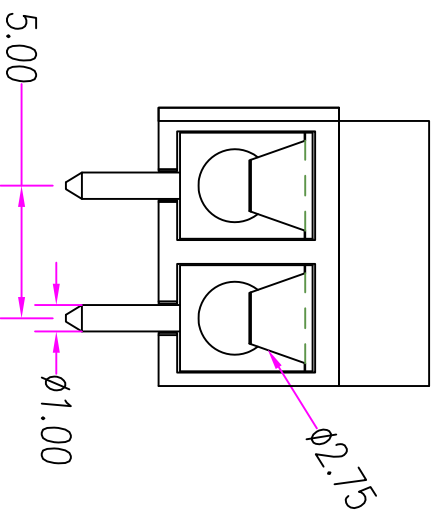
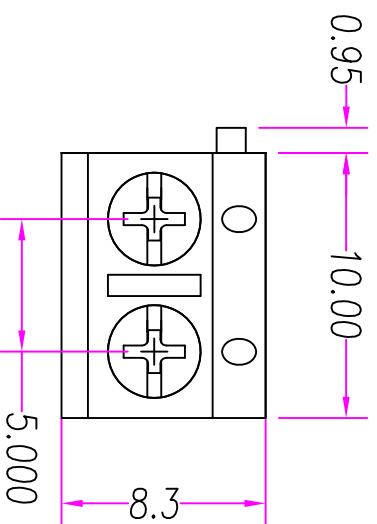

PCB circuit board hole tolerance recommended  $\pm 0.1$

Without individual tolerance reference	Individual tolerance reference	Marking	Product	Part	Item No.
0.5~3	3~6	6~30	30~120	>120	*****
$\pm 0.08$	$\pm 0.15$	$\pm 0.20$	$\pm 0.30$	$\pm 0.40$	6001

Marking	Product	Part	Item No.	Type
M M	M M	6001	6001	PCB Screw Terminal Block

