

REV	Revision	Drawing/Date	Audit/Date
A	New Issue	Chao Yu 22/08/2014	

- **Mechanical performance**
 Temperature range: 105°C
 Trim length: 9~10mm
 Torque: 1.2 N.m

- **Technical parameters (IEC) (UL)**
 Rated Voltage: 450v 300v
 Rated Current: 32A 25A
 Wire size: 4.0mm² 22-12AWG

- **requirement**
 the size with 'O' is the quality control.

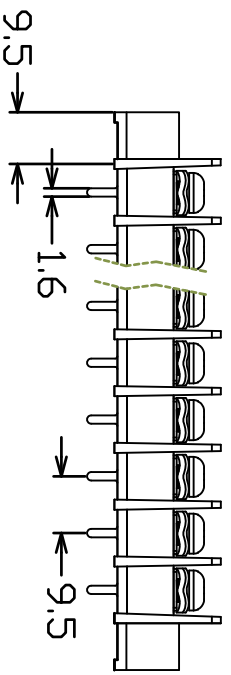
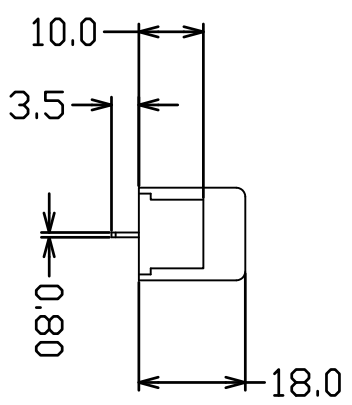
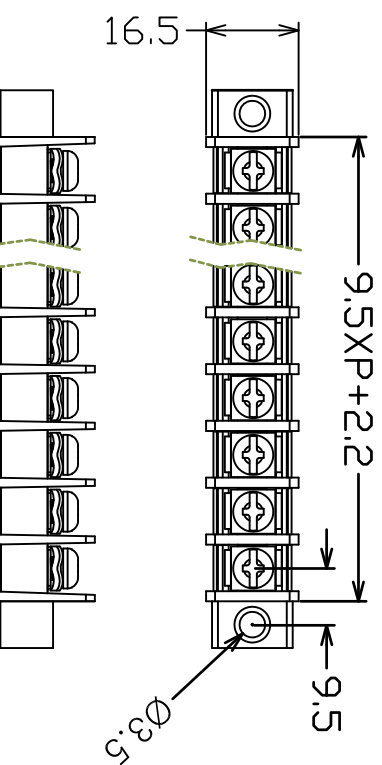
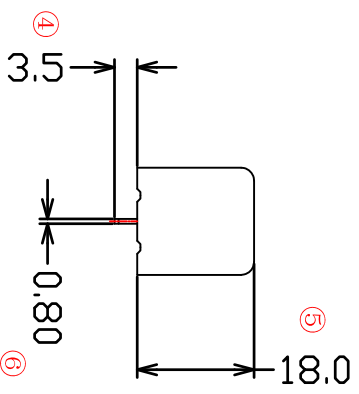
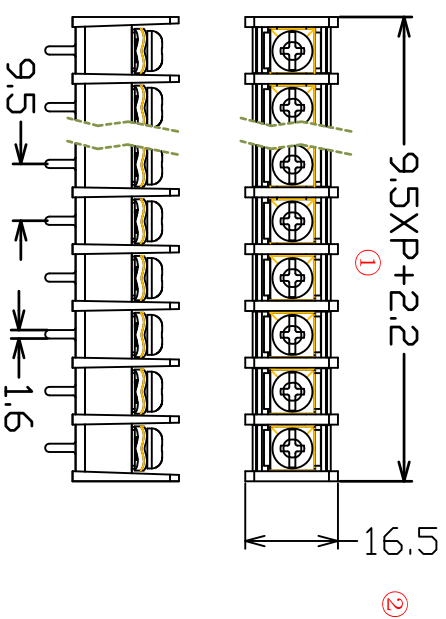

DIM	P	2	3	4	5	6	7	8	9	10	11	12
L		20.9	30.4	39.9	49.4	58.9	68.4	77.9	87.4	96.9	106.4	115.9
TOL(±)		0.15	0.15	0.15	0.25	0.25	0.35	0.35	0.45	0.45	0.55	0.55

Without individual tolerance reference				Drawing Categories	Product Diagram	Part No.	*****	
0.5~3	3~6	6~30	30~120	Dimension units	m		FUCOM-6038	
±0.08	±0.15	±0.20	±0.30	Production Method		Scale	1:1	Page A4

Item No.	Type
CM-45-C/MC-9.5-XXP	Plug-in Terminal Block

